

Enhanced Visualization and Control for Pelvic Laparoscopic Procedures

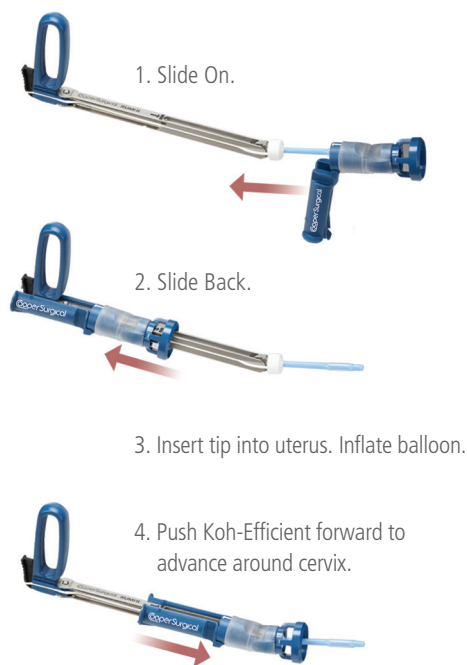
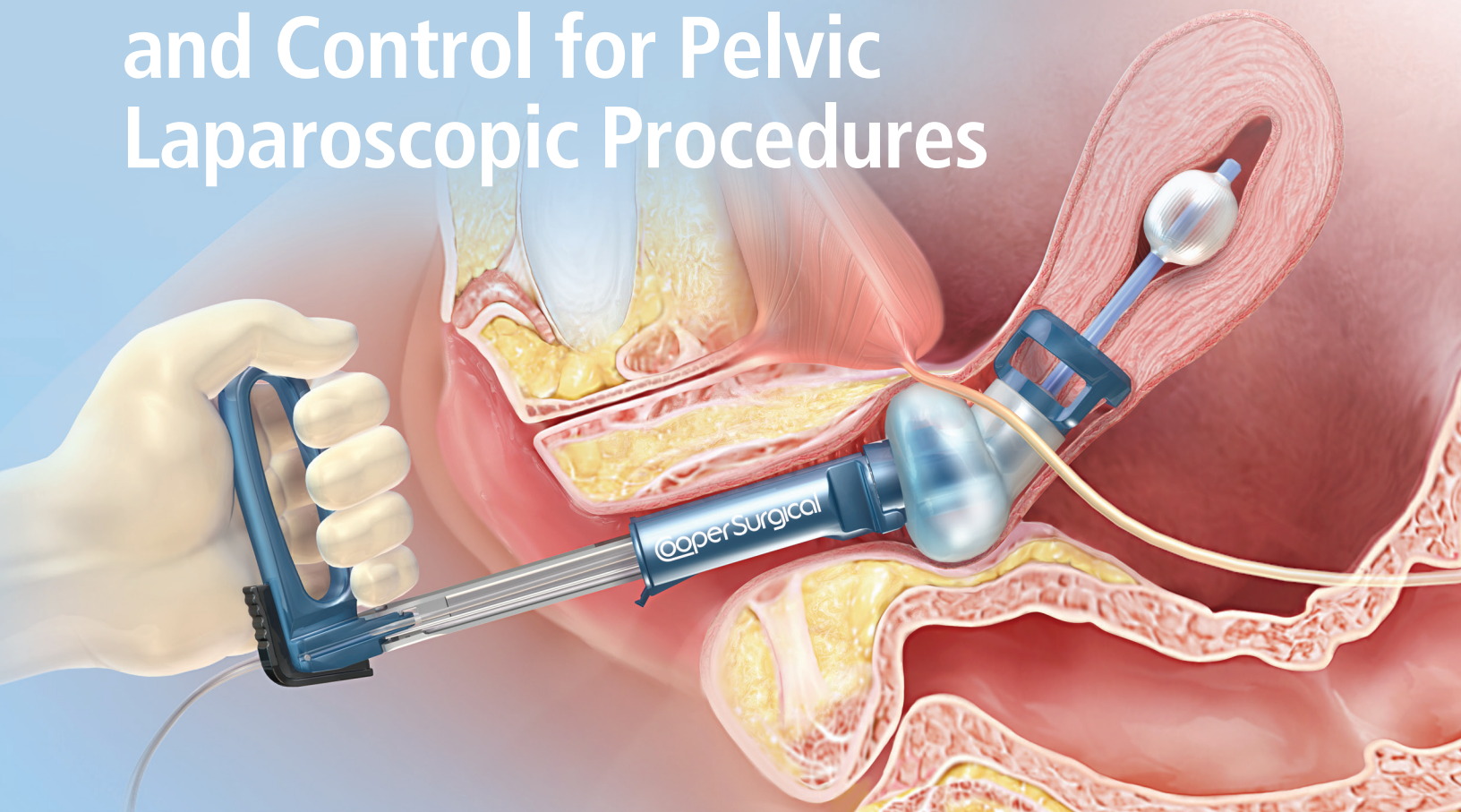

RUMI® II SYSTEM

Engineered With Our Koh-Efficient® System

The RUMI II System provides highly effective, safe uterine manipulation for any laparoscopic or robotic pelvic surgery. Surgeons will experience exceptional exposure and control of the uterus, and greater access to pelvic anatomy.

- Exceptional strength – Metal construction ensures durability and tactile feedback
- Precise control – 140° of articulation at the cervix, with locking handle
- Adjustable – Multiple tip and Koh Cup™ sizes provide unparalleled delineation of the fornix
- Quick set up – Integrated Koh Cup and pre-attached occluder balloon facilitates assembly
- Easy insertion – Easy load design permits insertion under direct visualization
- Excellent visibility – Koh-Efficient slides forward to securely lock cup in place around the cervix
- Longer length – Accommodates larger patients

During TLH procedures, the Koh-Efficient creates a 'margin of safety' by providing a visual landmark and backstop for full circumferential colpotomy, as well as distancing the ureters during the incision. Vaginal length is maximized and pneumoperitoneum is maintained.

CooperSurgical

Achieve Exceptional Control and Ideal Visualization with the RUMI® II System

- 2 inch longer shaft for better access
- 6 tip sizes accommodate individual patient anatomy
- Sacrocolpopexy and sacrocervicopexy tips available
- Koh-Efficient® technology for easy, fast, safe TLHs
- Catheter management system

RUMI II System Compatibility

- Uterine and Sacro tips are compatible with the RUMI II
- The Koh-Efficient systems are unique to the RUMI II.
- The original Koh Cup and Pneumo Occluder Balloon can be used with RUMI II
- The RUMI II is compatible with the ALLY UPS.



The Koh-Efficient® Creates a Margin of Safety by Providing a Visual Landmark and Backstop for Full Circumferential Colpotomy

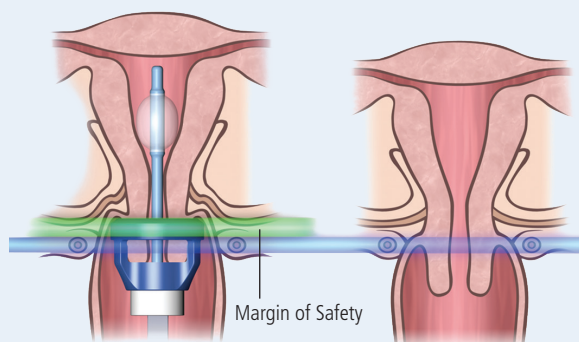

Ordering Information

Code	Product	Description
Uterine Manipulator Handle		
UMH650	RUMI II Handle	(1/each)
RUMI II Tips		
UMY514	RUMI II Tip Yellow	5.1 mm x 3.75 cm (5/box)
UML516	RUMI II Tip Lavender	5.1 mm x 6 cm (5/box)
UMW676	RUMI II Tip White	6.7 mm x 6 cm (5/box)
UMB678	RUMI II Tip Blue	6.7 mm x 8 cm (5/box)
UMG670	RUMI II Tip Green	6.7 mm x 10 cm (5/box)
UMO672	RUMI II Tip Orange	6.7 mm x 12 cm (5/box)
SACRO-1	Sacrocolpopexy Tip – Large	3.8 cm x 11.4 cm (3/box)
SACRO-1S	Sacrocolpopexy Tip – Small	3.2 cm x 9 cm (3/box)
SACRO-1C	Sacrocolpopexy Tip – Concave Distal End	3.8 cm x 11.4 cm (3/box)
Cervical Sizer		
KC-SIZER	Cervical Sizer	(1/each)
RUMI II Koh-Efficient System – For Electrosurgery Devices		
KC-RUMI-25	RUMI II / Koh-Efficient	2.5 cm (5/box)
KC-RUMI-30	RUMI II / Koh-Efficient	3.0 cm (5/box)
KC-RUMI-35	RUMI II / Koh-Efficient	3.5 cm (5/box)
KC-RUMI-40	RUMI II / Koh-Efficient	4.0 cm (5/box)
RUMI II Koh-Efficient System – For Harmonic Scalpel/Laser		
KCS-RUMI-25	Stainless Steel Capped RUMI II / Koh-Efficient	2.5 cm (5/box)
KCS-RUMI-30	Stainless Steel Capped RUMI II / Koh-Efficient	3.0 cm (5/box)
KCS-RUMI-35	Stainless Steel Capped RUMI II / Koh-Efficient	3.5 cm (5/box)
KCS-RUMI-40	Stainless Steel Capped RUMI II / Koh-Efficient	4.0 cm (5/box)

All RUMI Products are Latex Free

ALLY Uterine Positioning System®

AU-UPS	ALLY Uterine Positioning System
AU-CART	ALLY Uterine Positioning System Cart
AU-AD	Adapter Drape for RUMI II and Advincula Arch (5/Box)

CooperSurgical

Find out how the RUMI II System can benefit your practice and your patients. Call 800.243.2974 or visit www.coopersurgical.com.

203.601.5200 | coopersurgical.com | 95 Corporate Drive | Trumbull, CT 06611